

Pictures are only illustrative. They can differ from the visual shape of the selected product variant.

## Description

TFF is a circular supply diffuser for ceiling installation. It has adjustable vent capacity and a 360° discharge pattern from which up to 180° can be shielded by a deflector.

## Highlights

- Easy, precise air flow volume adjustment
- Non-disturbant aesthetic form
- Easy installation

## Design

TFF is made from galvanized steel sheet with powder colour coating. The product consists of the fixed part with fixing springs, equipped duct connection, the valve seat and the movable valve front plate. The front plate is held by the central thread bolt and can be moved by rotating. So the gap between the plate and the seat can be adjusted to set the required air flow volume.

# TFF-160-SW

Article no.: 161931

## Configuration

| Parameter      | Value                             |
|----------------|-----------------------------------|
| Size           | 160                               |
| Surface finish | Signal white (RAL9003, gloss 30%) |
| Discharge      | 180°                              |

Calculation

Pressure drop & sound power level (A-weighted)

Total sound power level (A-weighted) - Discharged into room

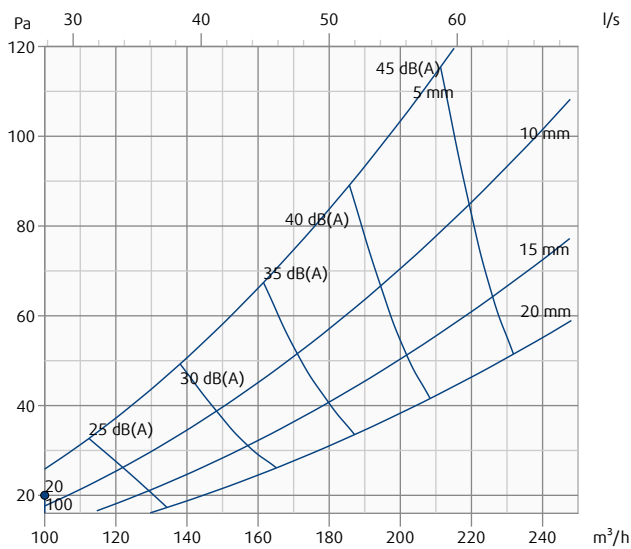

Throw length (terminal velocity 0.2 m/s)

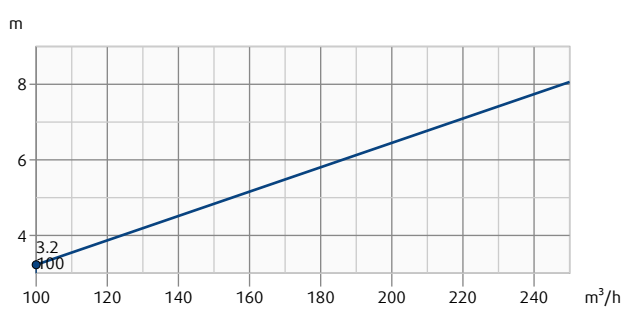

| Parameter  | Value |       |
|--|-------|-------|
| Air flow   | 100   | m³/h  |
| Pressure drop  | 20    | Pa    |
| Room temperature   | 22    | °C    |
| Supply temperature   | 22    | °C    |
| Damper setting   | 22    | %     |
| Total sound power level - Discharged into room                 | 34    | dB    |
| Total sound power level (A-weighted) - Discharged into room    | 22    | dB(A) |
| Total sound pressure level (10 m² room absorption, A-weighted) | <20   | dB(A) |

| Total sound power level - Discharged into room |       |    |     |     |     |    |    |    |    |
|--|-------|----|-----|-----|-----|----|----|----|----|
|  | Hz    | 63 | 125 | 250 | 500 | 1k | 2k | 4k | 8k |
| L <sub>W</sub>                                 | dB    | 33 | 27  | 20  | 9   | 5  | 7  | 14 | 22 |
| L <sub>WA</sub>                                | dB(A) | 7  | 12  | 11  | 5   | 5  | 8  | 15 | 20 |

Flow pattern

Room width (X): 4.000 m  
Room depth (Y): 3.000 m  
Room height (Z): 2.800 m

Position X: 2.000 m  
Position Y: 1.500 m  
Position Z: 2.800 m  
Angle: 0 °

Custom

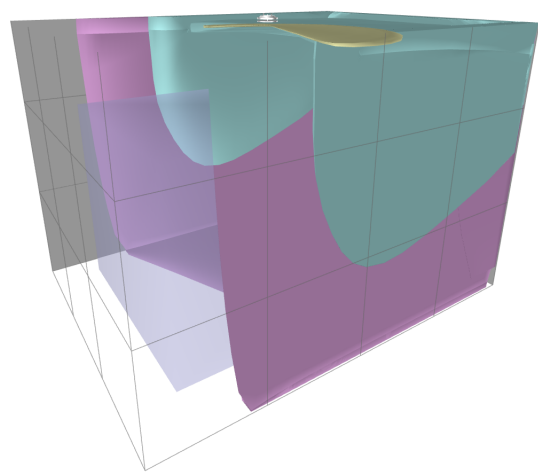

0.2 m/s      0.1 m/s      0.5 m/s

Top

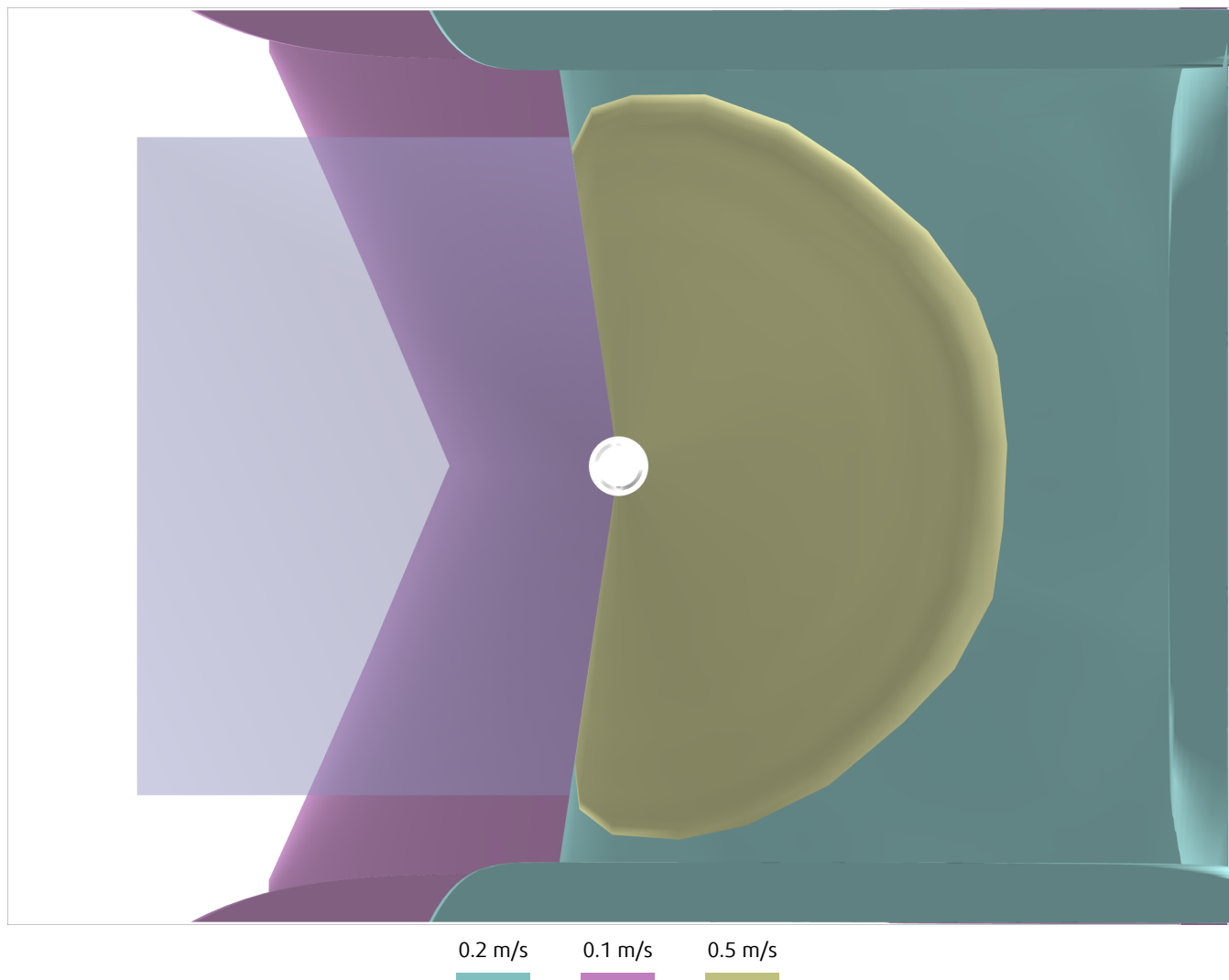

Left

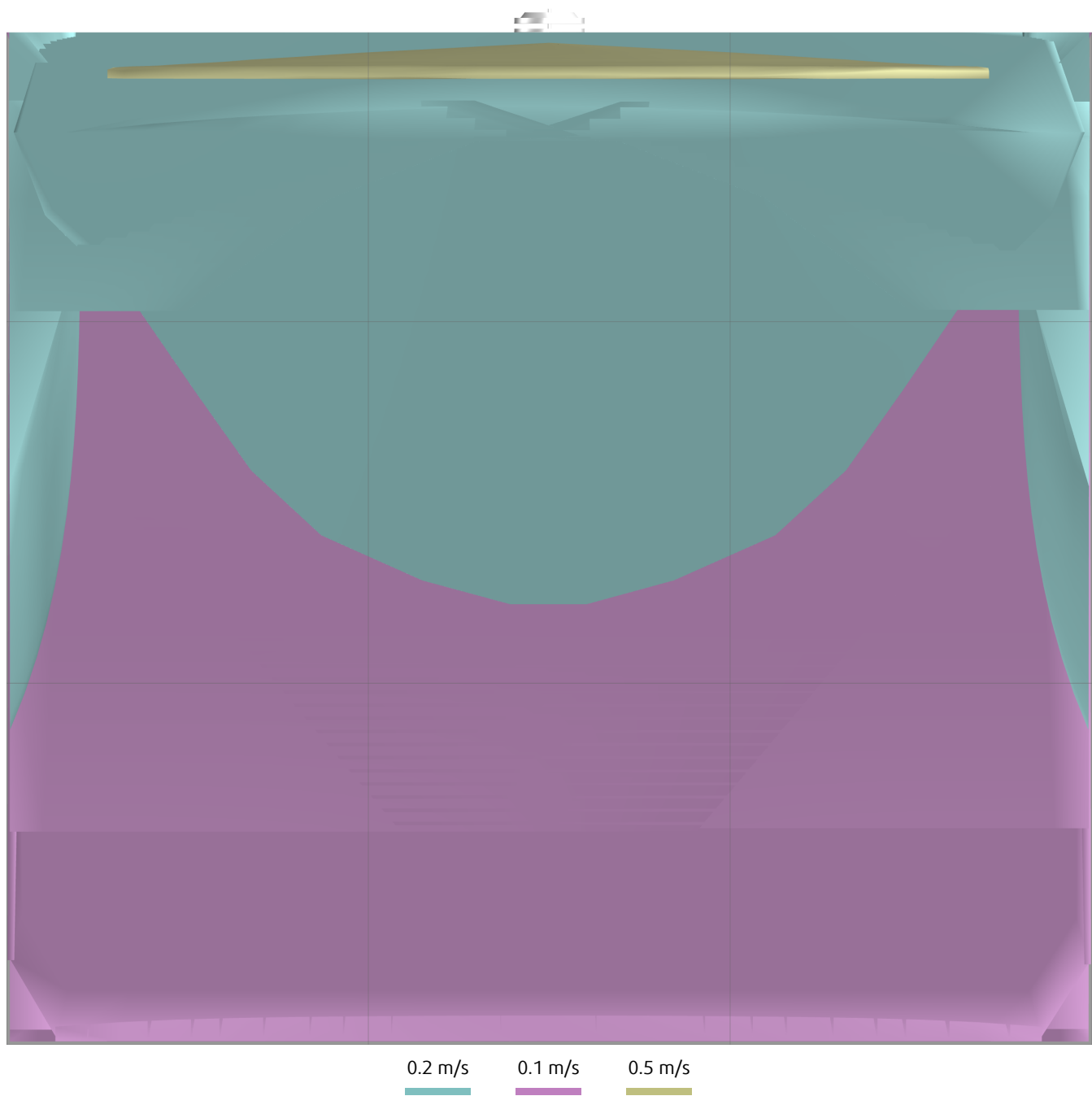

Southeast

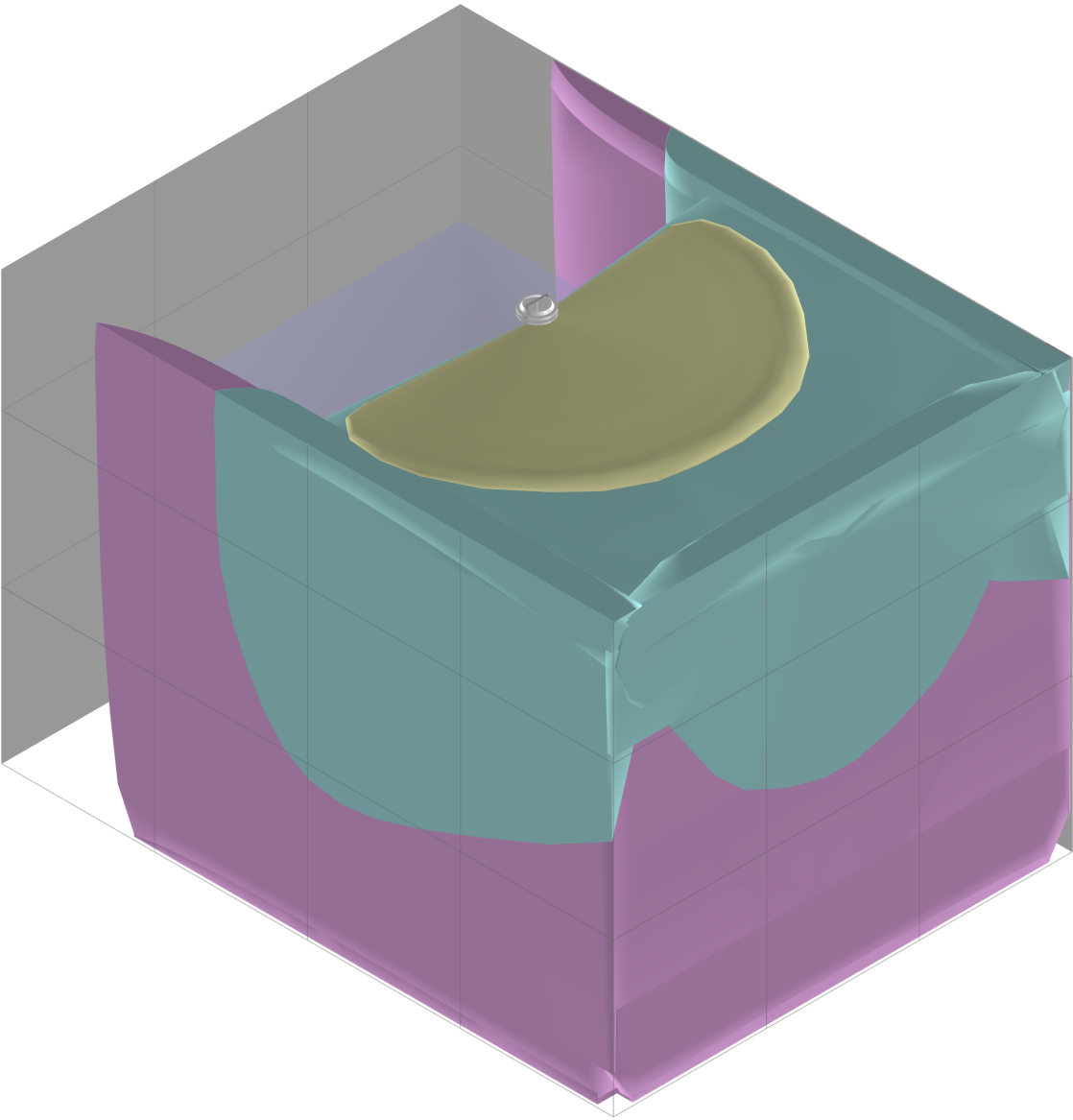

0.2 m/s      0.1 m/s      0.5 m/s

# TFF-160-SW

Article no.: 161931

## Dimensions

### Dimensions

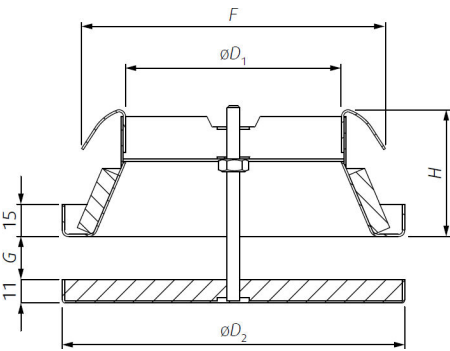

| Dimensions        | Value (mm) |
|-------------------|------------|
| $\varnothing D_1$ | 135        |
| $\varnothing D_2$ | 188        |
| F                 | 180        |
| G (max)           | 15         |
| H                 | 60         |

## Weight

| Part       | Weight (kg) |
|------------|-------------|
| TFF-160-SW | 0.47        |



## Documents

[DataSheet\\_TFF\\_EN\\_202105](#)

[DeclarationOfConformity\\_EFF,\\_EFFC,\\_TFF,\\_TFFC,\\_RSK,\\_IGC](#)

[UserManual\\_TFF\\_201909](#)